

**STREAM WATER APPLICATION
FOR 90-DAY PROVISIONAL TEMPORARY PERMIT**

OFFICE USE ONLY

Oklahoma Water Resources Board / Permitting Section

3800 N Classen Blvd - Oklahoma City OK 73118

Phone (405) 530-8800 - Fax (405) 530-8900 – Website: www.owrb.ok.gov

PT _____

SS _____

Submit one of the following filing fees: \$200.00 Standard Fee or \$300.00 Expedited Processing Fee or \$600.00 Post-use Fee (if water used prior to permit issuance). Add \$250.00 to the filing fee if the diversion is from a scenic river or outstanding resource water.

Applicant's Name _____

City _____ State _____ Zip _____

Contact Person / Title _____

Phone _____ Fax _____

Address / Box No. _____

E-mail / Cellular _____

Amount of surface water requested _____ acre-feet

(1 acre-foot = 325,851 U.S. Gallons)

Purpose: ☐ Irrigation of _____ acres

☐ Municipal ☐ Oil & Gas Drilling ☐ Industrial

☐ Other _____

Water to be diverted from: ☐ Stream ☐ Creek ☐ Pond

☐ SCS Site ☐ Lake ☐ Federal Reservoir

Name of source of water, if known _____

Rate of withdrawal will not exceed _____ gpm

Method of Diversion _____

Point of Diversion: _____ ¼ of _____ ¼ of _____ ¼

of Section _____ Township _____ Range _____

County _____

Area of Use: _____ ¼ of _____ ¼ of _____ ¼

of Section _____ Township _____ Range _____

County _____

Oil / Gas Lease Name _____

Applicant Owns: Land at the point of diversion? ☐ Yes ☐ No

Land on which water lines will be located? ☐ Yes ☐ No

If the answer to either of the above questions is NO, submit written consent from appropriate landowner(s).

Economic Hardship will occur if permit is not granted? ☐ Yes ☐ No

I verify that the above is true and accurate to the best of my knowledge, and that I will comply with all applicable laws and regulations of the State of Oklahoma.

Authorized Signature _____

Name of Signer _____

Please Print

If different from above:

Address _____

City _____ State _____ Zip _____

Phone _____ Fax _____

NOTARY

Subscribed and sworn before me

this _____ day of _____ 20 _____

Notary Public _____

My commission expires _____

(Seal)

INSTRUCTIONS FOR PLAT

- Spot location of diversion point(s). Sketch in: Ponds, Streams, Lakes, Water lines, etc.

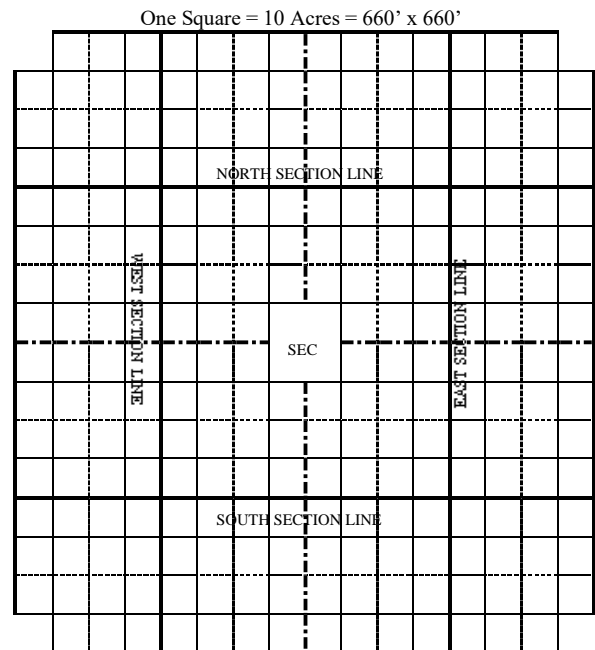

**NOTE: THE APPLICATION IS NOT APPROVED UNTIL
SIGNED BY THE EXECUTIVE DIRECTOR**

APPROVAL

This application is hereby approved in the amount of _____ acre-feet, subject to the following terms, conditions and limitations:

- (1) Provided existing appropriate rights and domestic uses downstream are not affected by this diversion of water.
- (2) This permit is valid for 90 days, does not vest the holder with any permanent water rights, and is subject to cancellation by the Board.
- (3) _____

Approved on the _____ day of _____ 20 _____

Expires on the _____ day of _____ 20 _____

Julie Cunningham, Executive Director